

NOTE:
OUTLINE OF DEVELOPMENT OUTSIDE THE APPLICATION LINE BOUNDARY IS INDICATIVE AND IS PROVIDED FOR CONTEXT INFORMATION ONLY.

PLEASE REFER TO BERNARD SEYMOUR LANDSCAPE ARCHITECTS DRAWINGS AND REPORT FOR ALL INFORMATION ON LANDSCAPE.

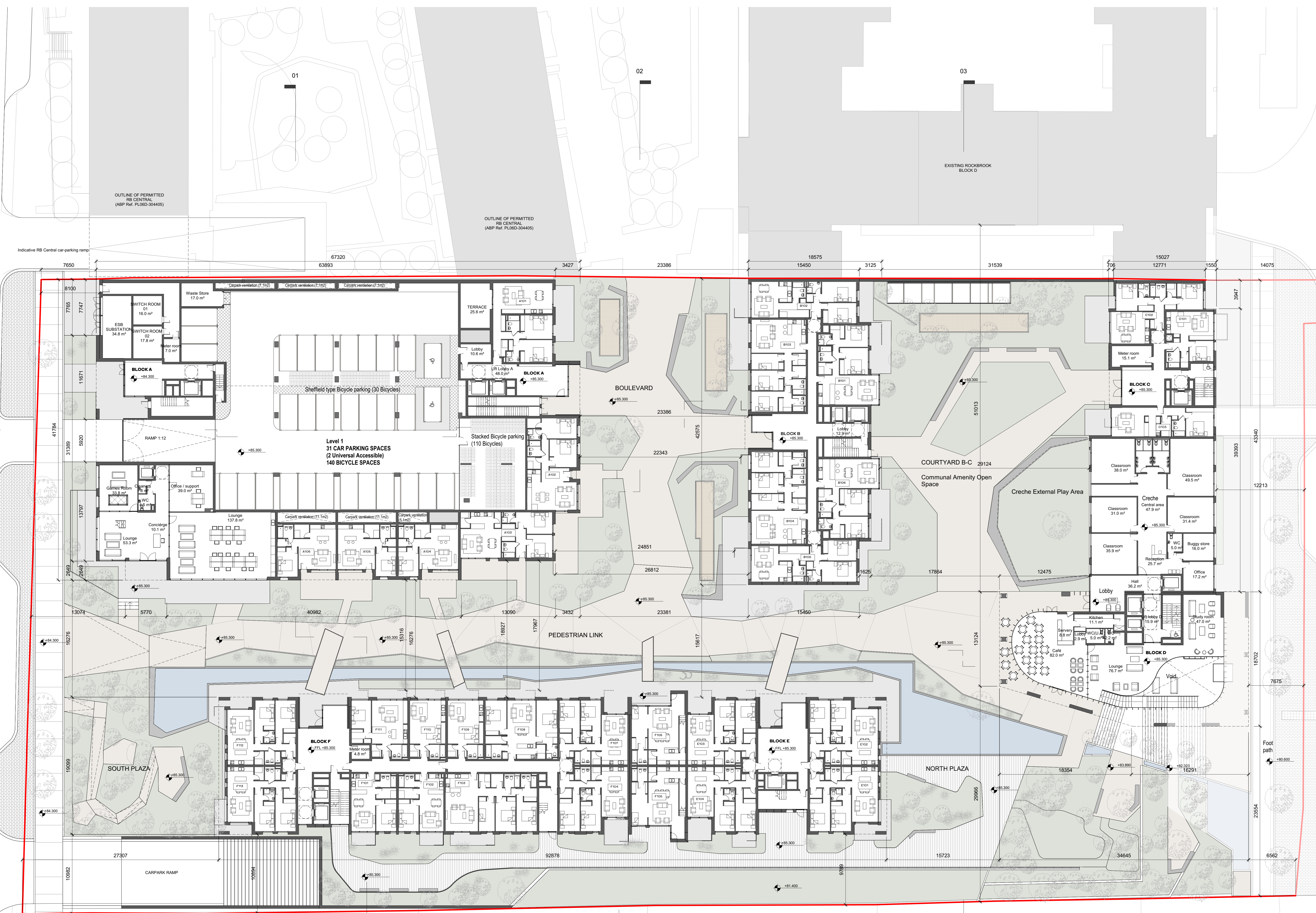

PROPOSED PEDESTRIAN AND ROAD INFRASTRUCTURE (SETDOWN) TO BE PROVIDED IN CONJUNCTION WITH DUN LAOGHAIRE RATHDOWN COUNTY COUNCIL

PROPOSED PEDESTRIAN AND ROAD INFRASTRUCTURE (SETDOWN) TO BE PROVIDED IN CONJUNCTION WITH DUN LAOGHAIRE RATHDOWN COUNTY COUNCIL

PROPOSED PEDESTRIAN AND ROAD INFRASTRUCTURE (SETDOWN) TO BE PROVIDED IN CONJUNCTION WITH DUN LAOGHAIRE RATHDOWN COUNTY COUNCIL

PROPOSED PEDESTRIAN AND ROAD INFRASTRUCTURE (SETDOWN) TO BE PROVIDED IN CONJUNCTION WITH DUN LAOGHAIRE RATHDOWN COUNTY COUNCIL

REV	DATE	DESCRIPTION	CHK	DRN
A2	15.11.2019	ISSUED FOR PLANNING APPROVAL	RJ	HJ
A1	18.07.2019	ISSUED FOR ABP PRE APPLICATION	RJ	BM

STATUS CODE DESCRIPTION
ISSUED FOR PLANNING APPROVAL

CLIENT
SANDYFORD GP Ltd.

PROJECT
SANDYFORD CENTRAL

DRAWING
PROPOSED LEVEL 01 BOULEVARD GROUND FLOOR PLAN

PROJECT NUMBER	DATE	
65572	18/07/2019	
SCALE @ A2:	DRAWN/CHECKED:	
1:200	BM/RJ	
STATUS CODE	DRAWING NUMBER	REVISION
A1	SFC-HJL-00-01-DR-A-1011	A2

Henry J Lyons

Architecture + Interiors
henryjlyons.com

+353 1 888 3333
info@henryjlyons.com

51-54 Parnass Street
Dublin D02 X466